

ZON<sup>®</sup>



**ZAC-30**  
**ZAC-30jr**  
User Manual

## **ZAC-30 and ZAC-30jr User's Guide**

©2005 Oxmoor Corporation, LLC

ZON, ZAC-30, ZAC-30jr, ZAC-60, ZIM-4, ZR-98 and Virtual Pointer are the trademarks and/or registered trademarks of Oxmoor Corporation, LLC. All other trademarks appearing in this document may be the trademarks and/or registered trademarks of their respective owner(s).

Specifications and designs subject to change.

Part Number: 1700091

Revision: 2.1/052005

# Table of Contents

---

<b>Important Safety Instructions</b> .....	<b>ii</b>
<b>End User Software License Agreement</b> .....	<b>iii</b>
<b>Introduction</b> .....	<b>1</b>
ZAC-30 Audio Controller/Amplifier .....	1
ZAC-30jr Controller/Amplifier .....	2
<b>Installation</b> .....	<b>3</b>
Installing in New Construction .....	3
Installing in Existing Construction .....	3
Connecting Wires to the ZAC-30 .....	4
Mounting the Controller .....	4
Connecting the Controller to the ZON System .....	5
<b>Using your ZAC-30 Controller</b> .....	<b>6</b>
<i>Working with ZAC-30 Controllers</i>	
Sleep/Background Mode .....	6
Adjust Volume .....	6
Select Audio Source.....	6
<i>ZAC-30 Functions and Features</i>	
Listening Enhancements .....	6
Bass and Treble.....	6
Balance.....	6
Loudness and EQ .....	7
<i>Working with ZAC-30jr Controllers</i>	
Adjusting Volume.....	7
Source Selection.....	7
Listening Enhancements .....	7
Controller Power Controls .....	7
<b>Technical Specifications</b> .....	<b>8</b>
<b>End User Notes</b> .....	<b>9</b>

## IMPORTANT SAFETY INSTRUCTIONS

1. Read and understand all instructions.
2. Follow all warnings and instructions marked on the product.
3. Do not use liquid or aerosol cleaners. Use a damp cloth for cleaning when necessary.
4. Do not subject this product to high humidity. Do not operate this equipment while you are in or near water (e.g., do not operate this equipment with wet hands).
5. Do not drop.
6. Slots present on components are provided for ventilation. To protect from overheating, these openings must not be blocked. This product should never be placed near or over a radiator or other heat source. This product should not be placed in a built-in installation where proper ventilation is not provided.
7. This product should be operated only from the type of power source indicated on the marking label. If you are not sure of the type of power supply to your home, consult your local power company.
8. Do not allow anything to rest on the power cord. Do not locate this product where the cord will be subjected to damage.
9. Never push objects of any kind into this product through cabinet/enclosure slots as they may touch dangerous voltage points or short out parts that could result in a risk of fire or electric shock. Never spill liquid of any kind on the product.
10. To reduce the risk of electric shock, do not disassemble this product. Opening or removing the covers, other than at the specified access points, may expose you to dangerous voltages or other risks. Incorrect reassembling can cause electric shock when the appliance is subsequently used.
11. Do not overload wall outlets and extension cords as this can result in the risk of fire or electric shock.
12. Unplug this product from the wall outlet and contact Oxmoor under the following conditions:
  - a. The power supply cord is damaged or frayed.
  - b. Liquid has been spilled into the product.
  - c. The product has been exposed to rain, water or excessive moisture.
  - d. The product does not operate normally by following the operating instructions. Adjust only those controls covered by these operating instructions, because improper adjustment of other controls may result in damage and will often require extensive work to restore the product to normal operation.
  - e. The product's cabinet/enclosure have been damaged or broken.
  - f. The product exhibits a distinct change in performance.
13. If you are unsure about the proper operation and/or installation of this product, contact Oxmoor or your authorized reseller for assistance.
14. Save these instructions.

**Oxmoor Corporation, LLC**  
**1-205-982-8200**  
**Internet: [www.zonaudio.com](http://www.zonaudio.com)**

### For Future Reference:

Date of Purchase: \_\_\_\_\_

Date of Installation: \_\_\_\_\_

Order Number/Details:

# END USER SOFTWARE LICENSE AGREEMENT

## IMPORTANT: READ BEFORE INSTALLING SOFTWARE OR USING ZON PRODUCTS

YOU SHOULD CAREFULLY READ THE FOLLOWING TERMS AND CONDITIONS BEFORE INSTALLING THE ACCOMPANYING SOFTWARE OR USING THIS PRODUCT. THE SOFTWARE AND THE PRODUCT CONTAIN SOFTWARE, THE USE OF WHICH IS LICENSED BY OXMOOR CORPORATION, LLC ("OXMOOR") TO ITS CUSTOMERS FOR THEIR USE ONLY AS SET FORTH BELOW. IF YOU DO NOT AGREE TO THE TERMS AND CONDITIONS OF THIS AGREEMENT, DO NOT INSTALL THE SOFTWARE OR USE THE PRODUCT. INSTALLING THE SOFTWARE OR USING ANY PART OF THE PRODUCT INDICATES THAT YOU ACCEPT THESE TERMS.

- **LICENSE:** The software which accompanies this license, whether imbedded within Oxmoor products or provided on media (the "Software") is the property of Oxmoor and is protected by copyright law. While Oxmoor continues to own the Software, you will have certain rights to use the Software after your acceptance of this license. Except as may be modified by a license addendum which accompanies this license, your rights and obligations with respect to the use of this Software are as follows:
- OXMOOR grants you a non exclusive license to use the accompanying software program(s) (the "Software") subject to the terms and restrictions set forth in this License Agreement. You are not permitted to lease, rent, distribute or sublicense the Software or to use the Software in a time-sharing arrangement or in any other unauthorized manner. Further, no license is granted to you in the human readable code of the Software (source code). Except as provided below, this License Agreement does not grant you any rights to patents, copyrights trade secrets, trademarks, or any other rights in respect to the Software.

The Software is licensed to be used on any applicable OXMOOR product, owned by you. You may reproduce and provide one (1) copy of the Software and supporting documentation for each such product on which the Software is used as permitted hereunder. Otherwise, the Software and supporting documentation may be copied only as essential for backup or archival purposes in support of your use of the Software as permitted hereunder. You must reproduce and include all copyright notices and any other proprietary rights notices appearing on the Software and the supporting documentation on any copies that you make.

- **NO ASSIGNMENT; NO REVERSE ENGINEERING:** You may not transfer or assign the Software and/or this License Agreement to another party without the prior written consent of OXMOOR. If such consent is given and you transfer or assign the Software and/or this License Agreement, then you must at the same time either transfer any copies of the Software as well as the supporting documentation to the same party or destroy any such materials not transferred. Except as set forth above, you may not transfer or assign the Software or your rights under this License Agreement.

Modification, attempting to discover the source code, reverse engineering, reverse compiling, creation of derivative works or disassembly of the Software is expressly prohibited.

**CONTINUED ON NEXT PAGE**

## END USER SOFTWARE LICENSE AGREEMENT

- **EXPORT RESTRICTIONS:** You agree that you will not export or re-export the Software or accompanying documentation (or any copies thereof) or any products utilizing the Software or such documentation in violation of any applicable laws or regulations of the United States.
- **TRADE SECRETS; TITLE:** You acknowledge and agree that the structure, sequence and organization of the Software are the valuable trade secrets of OXMOOR. You agree to hold such trade secrets in confidence. You further acknowledge and agree that ownership of, and title to, the Software and all subsequent copies thereof regardless of the form or media are held by OXMOOR.
- **TRADE SECRETS; TITLE:** You acknowledge and agree that the structure, sequence and organization of the Software are the valuable trade secrets of OXMOOR. You agree to hold such trade secrets in confidence. You further acknowledge and agree that ownership of, and title to, the Software and all subsequent copies thereof regardless of the form or media are held by OXMOOR.
- **UNITED STATES GOVERNMENT LEGEND:** The Software is commercial in nature and developed solely at private expense. The Software is delivered as a commercial item as defined in FAR 2.101(a) and as such is provided with only such rights as are provided in this License Agreement, which is OXMOOR's standard commercial license for the Software. Technical data is provided with limited rights only as provided in DFAR 252.227-7015 (Nov. 1995) or FAR 52.227-14 (June 1987), whichever is applicable. You agree not to remove or deface any portion of any legend provided in any license program or documentation to you under this License Agreement.
- **TERM AND TERMINATION:** This License is effective until terminated. Customer may terminate this License at any time by destroying all copies of Software including any documentation and ceasing to use the product(s). This License will terminate immediately without notice if Customer fails to comply with any provision of this License. Upon termination, Customer must destroy all copies of Software.
- **GOVERNING LAW:** This License Agreement shall be governed by the laws of the State of Alabama, United States of America. You agree that the United Nations Convention on Contracts for the International Sale of Goods (1980) is hereby excluded in its entirety from application to this License Agreement.

**NO WARRANTY:** THE SOFTWARE AND RELATED DOCUMENTATION ARE PROVIDED ON AN "AS IS" BASIS AND ALL RISK IS WITH YOU. OXMOOR MAKES NO WARRANTIES OR CONDITIONS, EXPRESS, IMPLIED OR STATUTORY AS TO ANY MATTER WHATSOEVER REGARDING THE SOFTWARE AND DOCUMENTATION. IN PARTICULAR, ANY AND ALL WARRANTIES AND CONDITIONS OF MERCHANTABILITY, FITNESS FOR A PARTICULAR PURPOSE OR NON-INFRINGEMENT OF THIRD PARTIES RIGHTS ARE EXPRESSLY EXCLUDED. FURTHER, OXMOOR MAKES NO REPRESENTATIONS, WARRANTIES OR CONDITIONS THAT THE SOFTWARE AND DOCUMENTATION PROVIDED ARE FREE OF ERRORS OR VIRUSES, OR THAT THE SOFTWARE AND DOCUMENTATION ARE SUITABLE FOR YOUR INTENDED USE.

**LIMITATION OF LIABILITY:** IN NO EVENT SHALL OXMOOR, ITS SUPPLIERS OR DISTRIBUTORS BE LIABLE TO YOU OR ANY OTHER PARTY FOR ANY INCIDENTAL, SPECIAL OR CONSEQUENTIAL DAMAGES, LOSS OF DATA OR DATA BEING RENDERED INACCURATE, LOSS OF PROFITS OR REVENUE, OR INTERRUPTION OF BUSINESS IN ANY WAY ARISING OUT OF OR RELATED TO THE USE OR INABILITY TO USE THE SOFTWARE AND/OR DOCUMENTATION, REGARDLESS OF THE FORM OF ACTION, WHETHER IN CONTRACT, TORT (INCLUDING NEGLIGENCE), STRICT PRODUCT LIABILITY OR OTHERWISE, EVEN IF ANY REPRESENTATIVE OF OXMOOR OR ITS SUPPLIERS HAS BEEN ADVISED OF THE POSSIBILITY OF SUCH DAMAGES.

**DISCLAIMER:** Some countries, states, or provinces do not allow the exclusion or limitation of implied warranties or the limitation of incidental or consequential damages for certain products supplied to consumers or the limitation of liability for personal injury, so the above limitations and exclusions may be limited in their application to you. This warranty gives you specific legal rights which may vary depending on local law.

**SEVERABILITY:** In the event any provision of this License Agreement is found to be invalid, illegal or unenforceable, the validity, legality and enforceability of any of the remaining provisions shall not in any way be affected or impaired and a valid, legal and enforceable provision of similar intent and economic impact shall be substituted therefor.

**ENTIRE AGREEMENT:** This License Agreement sets forth the entire understanding and agreement between you and OXMOOR, supersedes all prior agreements, whether written or oral, with respect to the Software, and may be amended only in a writing signed by both parties.

## Introduction

### ■ ZAC-30 Audio Controller/Amplifier

The ZAC-30 is designed for use as a sub-zone controller/amplifier (e.g. master bathroom, dining room, sun room, etc.). It is approximately half the size and power of the ZAC-60 Audio Controller/Amplifier, but has nearly all the features of its 60 watt counterpart.

Incorporating ZON's popular user interface, the ZAC-30 has a powerful 30 Watt digital stereo amplifier, built-in infrared receiver and adjustments for bass, treble, loudness and EQ settings. It is compatible with the functions and use of the ZIR-232 Device Commander.

Like other ZON digital products, it connects to the system with a single CAT-6 or CAT-5e cable. The ZAC-30 connects via an expansion jack on the ZAC-60. This allows the area covered by the ZAC-30 to share the same digital audio signal, but have independent control of volume and tone. The parent controller (ZAC-60) can be muted (or "off") and the ZAC-30 will continue to function with full capabilities, making the ZAC-30 a smart and powerful sub-zone solution.

Loudspeakers connect directly to the ZAC-30 by way of installation-friendly, removable screw terminals.

Faceplate and jog wheels are available in all of the ZON color and finish options.

[www.zonaudio.com](http://www.zonaudio.com)

Here are the key components of the ZAC-30 Audio Controller/Amplifier:

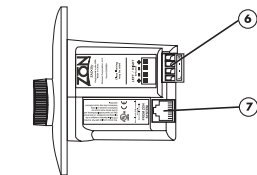

1. LCD Display
2. Volume Level Indicator (Virtual Pointer™)
3. Multi-Function Jog Wheel ("Knob")
4. Removable Faceplate
5. IR-Receiver
6. Removable Loudspeaker Connector
7. From ZAC-60 Expansion Connector

## ■ ZAC-30jr Audio Controller/Amplifier

The ZAC-30jr is designed for use as a sub-zone controller/amplifier (e.g. master bathroom, dining room, sun room, etc.). It is approximately half the size and power of the ZAC-60 Audio Controller/Amplifier, and has a simplified user interface.

Incorporating ZON's popular styling, the ZAC-30jr has a powerful 30 Watt digital stereo amplifier and a built-in infrared receiver. Adjustments for bass, treble, loudness and EQ settings are user-defined via the ZON Serial Configuration Utility (ZON Config).

Like other ZON digital products, it connects to the system with a single CAT-6 or CAT-5e cable. The ZAC-30jr connects via an expansion jack on the ZAC-60. This allows the area covered by the ZAC-30jr to share the same digital audio signal, but have independent control of volume and tone. The parent controller (ZAC-60) can be muted (or "off") and the ZAC-30jr functions with full capabilities, making the ZAC-30jr a simple and powerful sub-zone solution.

Loudspeakers connect directly to the ZAC-30jr by way of an installation-friendly, removable screw terminal.

Faceplate and jog wheels are available in all of the ZON color and finish options.

Here are the key components of the ZAC-30jr Audio Controller/Amplifier:

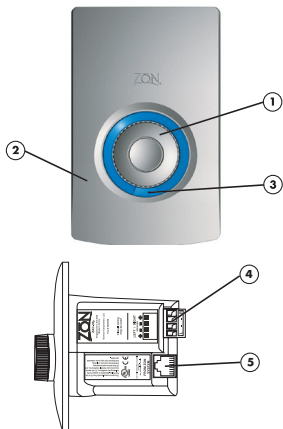

1. Multi-Function Jog Wheel ("Knob")
2. Removable Faceplate
3. IR Receiver
4. Removable Loudspeaker Connector
5. From ZAC-60 Expansion Connector



## Installation

---

### ■ **Installing the ZAC-30 / ZAC-30jr**

Before you install ZON system components, it is important to have all of the required wiring installed and tested. Please refer to the ZON system's Installation and User's guide for more information on the proper procedure for installing ZON components.

If you are installing this product as part of an authorized DIY kit, you may need to refer to additional instructional guides that will help you with planning and installing ZON wiring.

### **Installation in New Construction**

If you are installing the ZAC-30 during new construction, it is recommended that you use a standard, single gang rough-in trim ring. There are some single-gang electrical back boxes that may work with the ZAC-30. If your particular installation requires back boxes, it will be necessary to check that the ZAC-30 will fit the interior space of the box before installation.

Install ZAC-30s so that the center of the rough opening for the device is approximately 56" above the finished floor. This will provide optimal viewing of the LCD screen.

The ZAC-30jr can be installed at any desired height above the finished floor.

### **Installation in Existing Construction**

If you are installing the ZAC-30 in existing construction it is recommended that you use a single-gang low-voltage trim ring, provided that your local building codes will allow the use of this type of mounting apparatus.

Before cutting a hole in your wall, make sure that your target location does not interfere with any obstructions behind the wall (studs, conduit, etc.).

If you are installing a ZAC-30, you will want to locate the center of the trim ring so that it is approximately 56" above the finished floor. This will provide optimal viewing of the LCD screen.

The ZAC-30jr can be installed at any desired height above the finished floor.

In addition to the requirements listed above, it is also recommended that you take care to position the trim ring so that it is plum and square. The ZAC-30 mounts directly to the device mount screw holes on the trim ring, so major adjustments (up, down, left or right) are not possible once the trim ring is installed.

It is also a good idea to make sure that you allow at least 1.5 inches of clearance around the trim ring (when mounting next to switches, trim, etc.).

## Connecting Wires to the ZAC-30

Following your wiring plan, you should have these cables ready for connection to the controller:

- A CAT-6/CAT-5e cable that runs from the rough opening to the EXPANSION jack of a ZAC-60 controller.
- Two speaker wire pairs that run from the rough opening to a pair of loudspeakers used in the room.

Connect the following wires:

- Connect the CAT-6/CAT-5e cable to the “FROM ZON SYSTEM” jack.
- Connect the speaker wires to the controller’s loudspeaker connection. Be sure that you maintain proper polarity (+ to + and - to -).

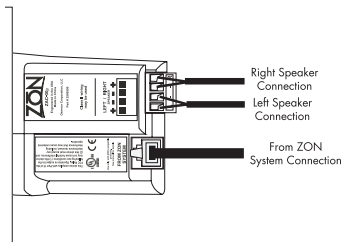

## Mounting the Controller

Mounting the controller is straightforward, using these steps:

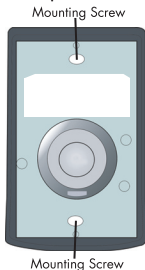

1. Carefully remove the controller’s faceplate by lifting up and out on the cover from the center of the lower edge of the faceplate.
2. Align the controller’s provided 6/32 screws with the threaded holes on the back box or trim ring.
3. Place the controller into the box or rough opening behind the

trim ring, taking care not to crimp or bind the wire connected to the controller. Push back on the controller so that it touches the mounting surface.

4. Tighten the mounting screws. It is recommended that you use only a manual screwdriver for this operation to protect the mounting screws and the controller’s display and circuit board.
5. Carefully reinstall the faceplate. Place the top edge of the faceplate on the top edge of the controller and snap in place by applying even pressure to the bottom center of the faceplate.

## Connecting A Controller to the ZON System

At the parent ZAC-60, locate the EXPANSION jack. This jack is located on the back of the ZAC-60 next to the CAT-6/CAT-5e jack that connects the ZAC-60 to the ZON router. Connect the CAT-6/CAT-5e cable from the ZAC-30 to the EXPANSION jack on the ZAC-60.

*Do not connect a ZAC-30 directly to a ZR-98 Router. The ZAC-30 will not function, and it could cause damage to both the controller and the ZR-98 router.*

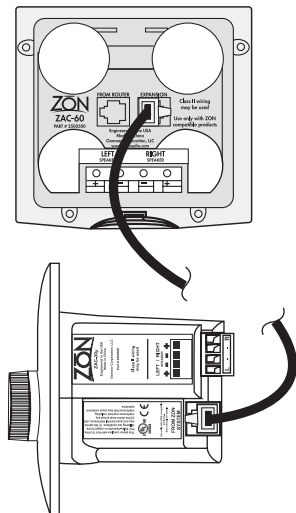

## Using your ZAC-30 Controller

### ■ Working with ZAC-30 Controllers Sleep/Background Mode

After a period of inactivity, your controller will automatically enter a “sleep” mode. The display and volume indicator ring are slightly illuminated. Turn or press the wheel to activate the controller’s back light.

### Adjust Volume

Turn the jog wheel to adjust volume. The Virtual Pointer gives a visual indication of the volume level.

A flashing LED on the Virtual Pointer indicates loudspeaker mute.

To manually mute, turn the wheel all the way down. You can also mute directly from a ZON mini remote (not included).

### Select Audio Source

Briefly press the jog wheel. The display will change to the SELECT SOURCE menu.

Turn the wheel left or right to view available sources. Press the jog wheel once to select the source shown on the display.



Virtual Pointer™ shows current volume level. Use jog wheel to adjust volume.



Press briefly to make source selection. Turn left or right to scroll through source list.

### ■ ZAC-30 Functions and Features

#### Listening Enhancements

The ZAC-30 provides tone and balance controls, EQ presets and loudness compensation. To access these features, press and briefly hold the jog wheel. The display will change to the CHOOSE FUNCTION menu. Turn the knob left or right to view the available functions. Press the knob to select the function shown on the display.

#### Bass and Treble

The bass and treble adjustment functions are available in the CHOOSE FUNCTION menu. Adjust the amount of bass and treble you desire by turning the jog wheel.

Briefly press to select and exit the adjustment screen. There is 6 dB of boost and cut provided for each of these tonal settings.



#### Balance

The balance adjustment function is available in the CHOOSE FUNCTION menu. Adjust the amount

of balance you desire by turning the jog wheel. Briefly press to select and exit the adjustment screen.



## Loudness and EQ

The loudness and EQ adjustment functions are available in the CHOOSE FUNCTION menu.

When you listen to music in the background, loudness compensation can be used to enhance low and high frequencies that are lost in low volume situations. To enable/disable loudness compensation, turn the knob right to move the cursor to ON (or left to move cursor to OFF). Briefly press the knob to select and exit the adjustment screen.

The EQ menu shows available EQ presets. To choose a preset, turn the knob to move the cursor up and down the list. If you are listening to music you will hear the changes in the audio when you move the cursor. Briefly press the knob to select and exit the adjustment screen.

## Leaving CHOOSE FUNCTION Menu

To leave the CHOOSE FUNCTION menu, scroll with the jog wheel until the display reads "EXIT". Briefly press the knob to exit and return to the NOW PLAYING screen.

## Controller Power Controls

To turn the controller off, press and hold the jog wheel until "TURNING OFF" is shown on the display. You can also turn the power off by pressing the POWER button on a ZON mini remote.



## Working with ZAC-30jr Controllers

### Adjusting Volume

Turn the jog wheel left or right to adjust the volume level. You can also use the ZON mini remote for this function.

### Source Selection

A ZON mini remote is required for changing the active audio source on the ZAC-30jr. Use the SOURCE SELECT buttons to scan through the sources that are available to the ZON system. The mini remote provided with a ZAC-60 is compatible with ZAC-30 and ZAC-30jr.

### Listening Enhancements

To adjust default settings for bass, treble, balance, loudness and EQ for the ZAC-30 and ZAC-30jr use the ZON Serial Configuration Utility.

### Controller Power Controls

To turn the controller off, press and hold the jog wheel until "TURNING OFF" is shown on the display. You can also turn the power off by pressing the POWER button on a ZON mini remote.

# Technical Specifications

	ZAC-30	ZAC-30jr
<b>Amplification</b>		
Type	Digital Stereo	Same
Power	30 Watts (15W x 2) RMS @ 6 ohm	Same
Amplifier Efficiency	> 90%	Same
Frequency Response	20 Hz - 20 kHz	Same
Noise Floor	< -102 dBFS @ 1 KhZ 'A' Weighted	Same
THD + N	< 0.1 % @ 1 kHz, Maximum Power	Same
	<0.05 % @ 1 Watt	Same
Loudspeaker Impedance	4 - 8 ohms	Same
Loudspeaker Connection	Mini-Screw Terminals (L & R x 2)	Same
<b>Controller</b>		
Jog Wheel	Multi-Function Shaft Encoder	Same
Jog Wheel Indicator	Virtual Pointer™	None
Graphical User Interface	High Resolution Graphical User Interface with Icons	None
Remote Control	Compatible with all functions of ZON mini remote	Same
Volume Control	Adjustable via shaft encoder Independent level from ZAC-60 parent controller	Same
Source Selection	Adjustable via shaft encoder or IR Remote Remotely selects parent ZAC-60 Source	IR Remote Only Same
User Defined Labels	Available	None
Digital Signal Processing Equalization	Integrated onboard User-selectable Presets via GUI and setup software	Same User-selectable Presets via setup software only
Tone Control	User-selectable Bass, Treble and Loudness via GUI and setup software	User-selectable Bass, Treble and Loudness via setup software only
Balance Control	User-selectable Presets via GUI and setup software	User-selectable Presets via setup software only
IR Receiver	38 kHz pass through to selected input*	same*
Paging	Receives pages from ZON system Cannot originate pages	Same Same
<b>Connections</b>		
Wiring Specifications	CAT-6 or CAT-5e Class II, 4 twisted pair (100 ohm Impedance)	Same Same
Connection	8P8C Modular Jack from ZAC-60 Expansion Port	Same
Termination Method	568-A or 568-B	Same
<b>Mounting</b>		
Design Principle	In-wall single gang mounting ring	Same
<b>Other</b>		
Agency Approvals	UL, C, CE, FCC (Part 15 Class B)	Same
Front Panel Dimensions	2 13/16" W x 4 1/2" H	Same
Depth Behind Wall	3 inches	Same
Colors	ZON Standard Color Palette	Same
Shipping Weight	Approx. 1 Pound	Same

\*When used with ZAC-60 that has a serial number VA0105-XXXXXX or greater

## **End User Notes**

---

Worldwide Distribution by



3502 Woodview Trace, Suite 200

Indianapolis, IN 46268

Phone: 317-860-8100

Toll Free: 800-544-1482

[www.klipsch.com](http://www.klipsch.com)

[www.zonaudio.com](http://www.zonaudio.com)

**Part Number 1700091**

**Revised May, 2005**